

Lloyd's Register of Shipping.

Ship's Name

YOKEFLEET

Official No. 129515.

Memorandum of alterations reported since ship was surveyed for assignment of Load Lines
in September 1937.

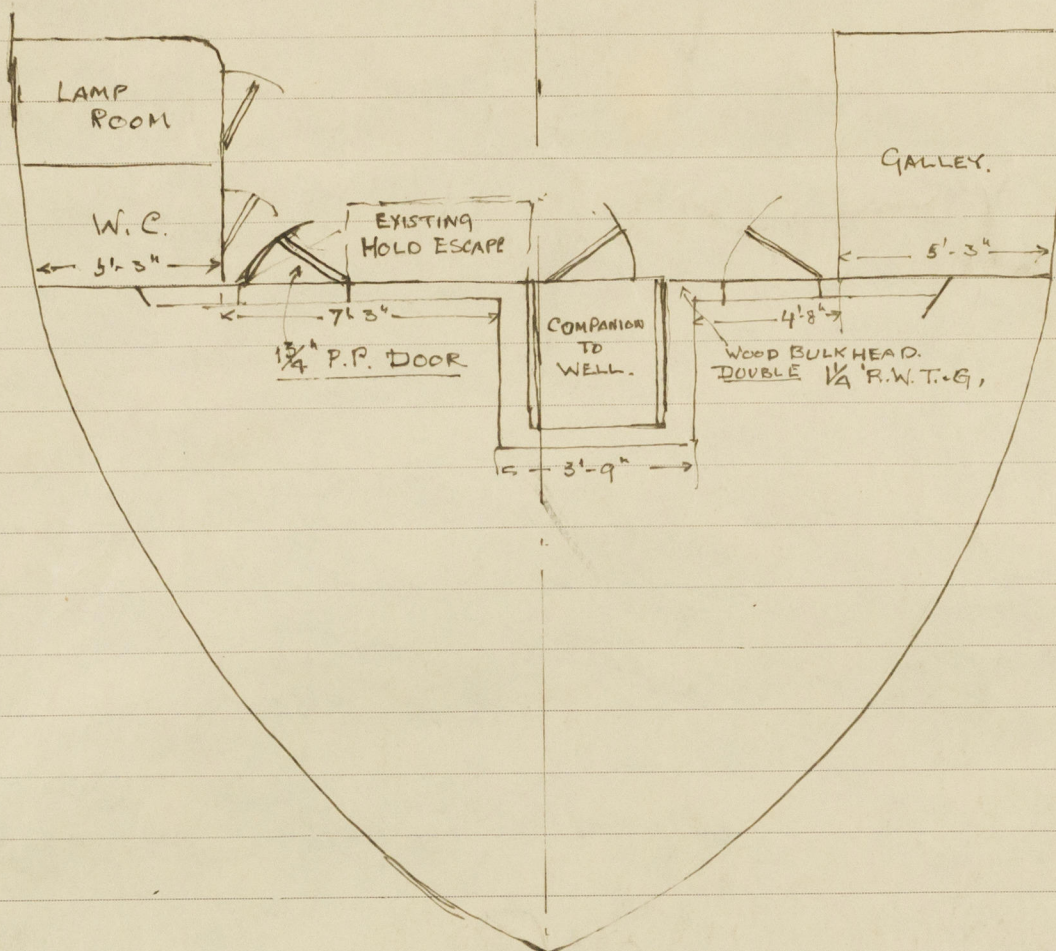

Crews. Accommodation removed from below main deck to fo'castle.
Wood bulk head double thickness $1\frac{1}{4}$ " R.W. T & G. fitted across
between existing steel bulkheads, with two $1\frac{3}{4}$ " P.P. Doors.
Gills 18" high.

Noted
8/1/41

[Signature]

