

Lloyd's Register of Shipping.
SURVEYS FOR FREEBOARD-STEAMERS.

Ship's Name. <u>BRITISH FAITH.</u>	Port of Registry and Nationality. <u>British</u>	Official Number. <u>149944</u>	Gross Tonnage. <u>✓</u>	Date of Build. <u>1924</u>	Particulars of Classification. <u>+ 100 A1 Carrying Petroleum in Bulk.</u>
Number in Register Book					
Moulded dimensions <u>440.0 x 56.45 x 33.92</u>					
Moulded displacement at a moulded draught of 85 per cent. of moulded depth <u>See Back.</u>					
Coefficient of fineness for use with tables <u>.781</u>					

DEPTH FOR FREEBOARD.			CORRECTION FOR LENGTH.		
Moulded depth	...	33.92	(a) When D is greater than $\frac{L}{15}$		
Stringer plate06	$(D - \frac{L}{15}) \times R = (33.98 - 29.33) \times 3$	+ 13.95	
Sheathing in wells $T(\frac{L-S}{L}) =$...	-	(b) When D is less than $\frac{L}{15}$ (if allowed).		
			$(\frac{L}{15} - D) \times R =$		
Depth D =	...	33.98	If restricted by height of superstructures		

SUPERSTRUCTURES.					
	Mean Covered Length S.	Equivalent Enclosed Length S ₁ .	Height.	Correction for Height.	Effective Length.
Poop enclosed	103.14	103.14	8'-0"	✓	103.14
" overhang					
R.Q.D. enclosed					
" overhang					
Bridge enclosed	33.83	33.83	8'-0"	-	33.83
" overhang aft					
" overhang forward					
F'cle enclosed	53.58	49.64	8'-0"	-	49.64
" overhang					
Trunks forward					
" aft					
Tonnage opening					
TOTAL = <u>190.58</u> <u>186.64</u> <u>186.64</u>					
Length of ship (L) = <u>440.0</u> <u>440.0</u> <u>440.0</u>					
% Covered ... = <u>43.31</u> <u>42.42</u> <u>42.42</u>					
Corresponding % corrected for absence of fore-castle if required } <u>Lanker</u> = <u>33.42</u> Correction for Bridge less than .2L if required } <u>Lanker</u>					
Allowance ... = <u>42.00</u> × <u>.3342</u> = <u>- 14.04</u>					

SHEER AFT.

Actual		Standard	
51.5	1	51.5	54.0
12.0	3	36.0	42.0
- 1.5	3	- 4.5	6.0
-	1	-	1
83.0		144.0	

Sheer aft = $\frac{83.0}{144.0}$ 57.64% of Standard

SHEER.					
Station.	Actual Sheer.	Standard Sheer.	Allowed Sheer.	S. M.	Products.
A.P. 1	51.5	54.0	51.5	1	51.5
2	12.0		12.0	4	48.0
3	- 1.5		- 1.5	2	- 3.0
4	-		-	4	-
5	18.5	12.0	13.99	2	27.98
6	52.45	48.0	49.45	4	197.80
F.P. 7	105.5	108.0	105.5	1	105.5
18) <u>427.78</u>					
Mean effective sheer ... = <u>23.47</u>					
Standard sheer .05L + 5 = <u>24.00</u>					
Difference (Df) ... = <u>3.23</u>					
Allowance = $Df \times (\frac{.75 - S}{2L}) = 3.23 \times (\frac{.75 - 2165}{2 \times 440}) =$ <u>+ 1.72</u>					
If limited on account of amidship superstructure ... =					
If limited on account of excess sheer (1½ in. per 100 ft.) ... =					

If excess sheer forward and deficient sheer aft :—

Actual sheer aft	=	Deficient 57.64% of standard
Standard sheer aft		
Actual sheer forward	=	Excess.
Standard sheer forward		

Length of enclosed superstructure L

Forward of amidships = } Lanker
Aft of amidships = }

ROUND OF BEAM.		TABULAR FREEBOARD (corrected for flush deck if required) = <u>42.50.</u>	
Standard	13.62	Corrected for Coefficient $\frac{.781 + .68}{1.36} =$	<u>1.044</u> = <u>44.89</u>
Ship	14.00		
Difference	.38		
Restricted to			
Allowance = $\frac{\text{Difference}}{4} \times (1 - \frac{S}{L}) =$	$\frac{.38}{4} \times .5458 =$		<u>-.05</u>
33.98 6.62 49.44 <u>424.36</u> 6.84 <u>86.31</u>			
		Correction for Length ... <u>13.95</u>	
		" Superstructures ... <u>14.04</u>	
		" Sheer ... <u>1.72</u>	
		" Round of beam ... <u>.05</u>	
		" Thickness of deck ... <u>✓</u>	
		" Scantlings, etc. ... <u>✓</u>	
		" Statutory deck line ... <u>✓</u>	
		15.64 14.09 + 1.58	
		Summer Freeboard = <u>49.44</u>	

FREEBOARD recommended amidships from centre of Disc to top of Statutory Deck Line, Wood (Steel) Deck :—

Fresh Water Line	above centre of Disc
Indian Summer Line	"	"	"	"	"
Winter Line	below	"	"	"	"
Winter North Atlantic Line	"	"	"	"	"

1906 lbs. $4'-4\frac{3}{4}"$ } Diff $S = -12\frac{1}{4}"$
 $8'-2"$ } $W = -11\frac{1}{4}"$

© 2020
Lloyd's Register Foundation
002024-002037-0030

515

Index No.	Actual	0	18.5	52.75	108.5
Part of ship	Standard	0	10.0	48.0	108.0
Part of ship	diff	0	6.5	4.75	
Name of ship	$\times \frac{7.64}{28}$	0	1.99	1.45	
Particulars of Classification	Standard	0	12.0	48.0	
	allowed	0	13.99	49.45	105.5

$8\frac{1}{2}\% \text{ of } 33.92 = 28.832$
 $26' - 4\frac{1}{2}"$ mld. = 14680
 $29\frac{1}{2}\% \text{ of } 49.5 = 1460$
 16140

$16140 \times .995 \times 35$
 $440 \times 56.75 \times 28.832$
 181

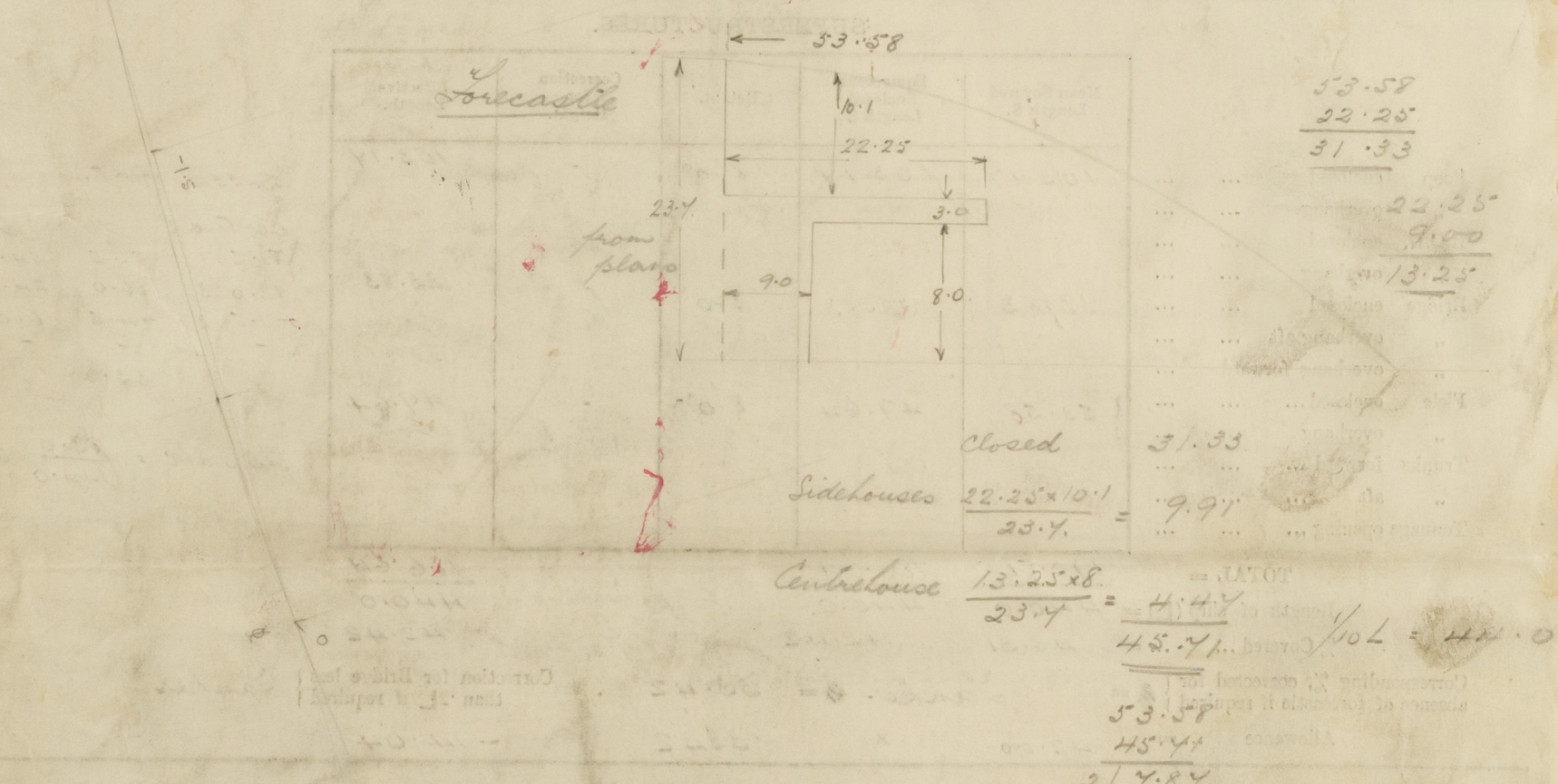

Particulars	Volume	Area	Weight
Sidehouses	9.91		
Centrehouse	4.44		
Total	14.35		

It is noted on account of excess space (1) in the ...
It is noted on account of excess space (2) in the ...

Particulars	Volume	Area	Weight
Sidehouses	9.91		
Centrehouse	4.44		
Total	14.35		