

JOB N° 38/102

FAN CHAMBER ON UPPER PROMENADE DECK

SCALE: $\frac{1}{4}$ " = 1 FOOT

CHAMBER TO BE SOUND INSULATED (SLAB, CORK)

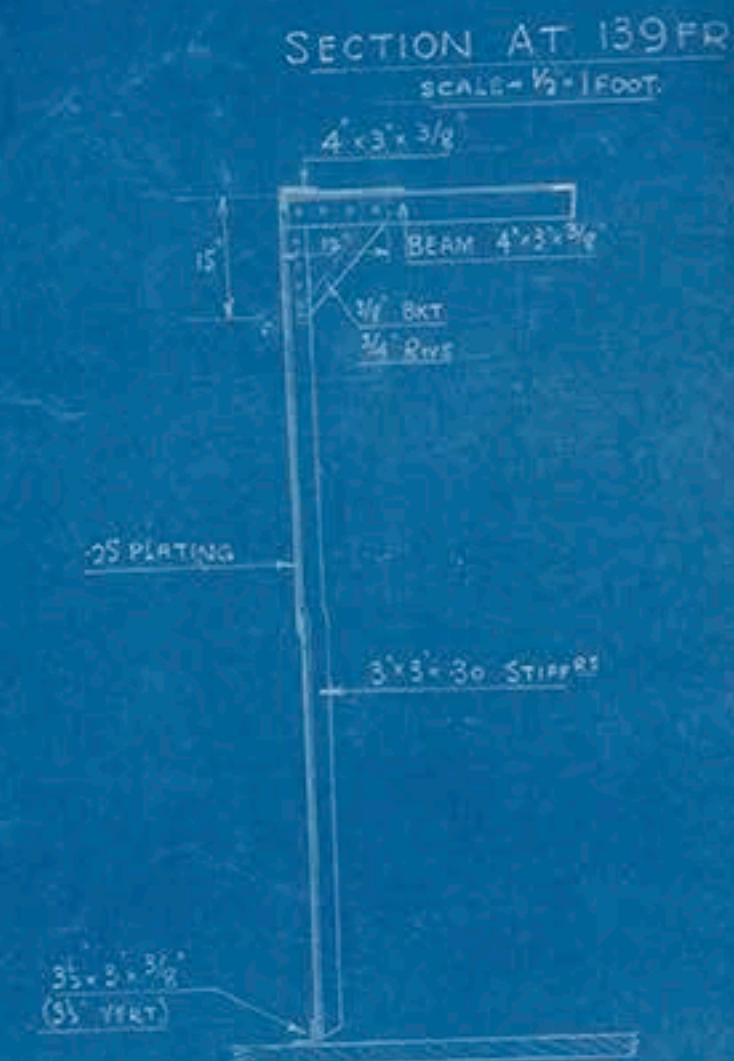
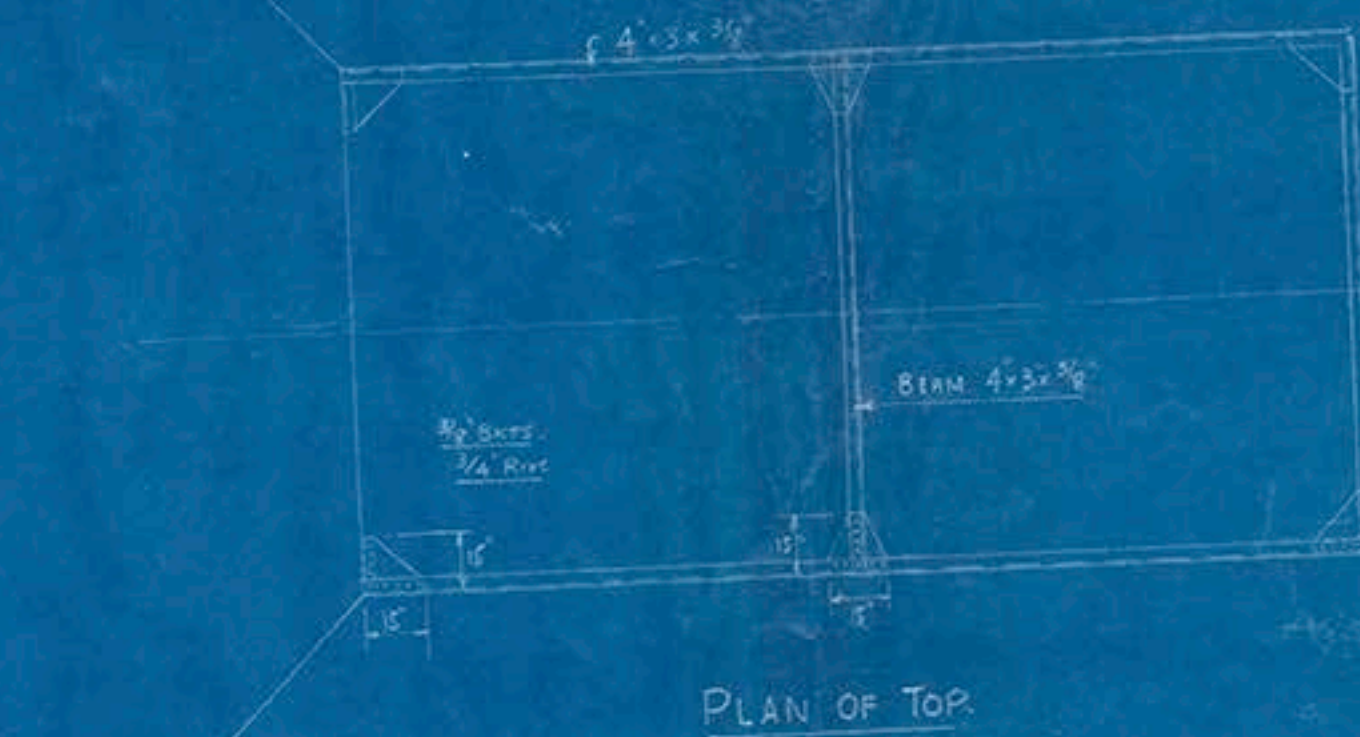

ELEVATION OF PORT SIDE
LOOKING TO PORT.

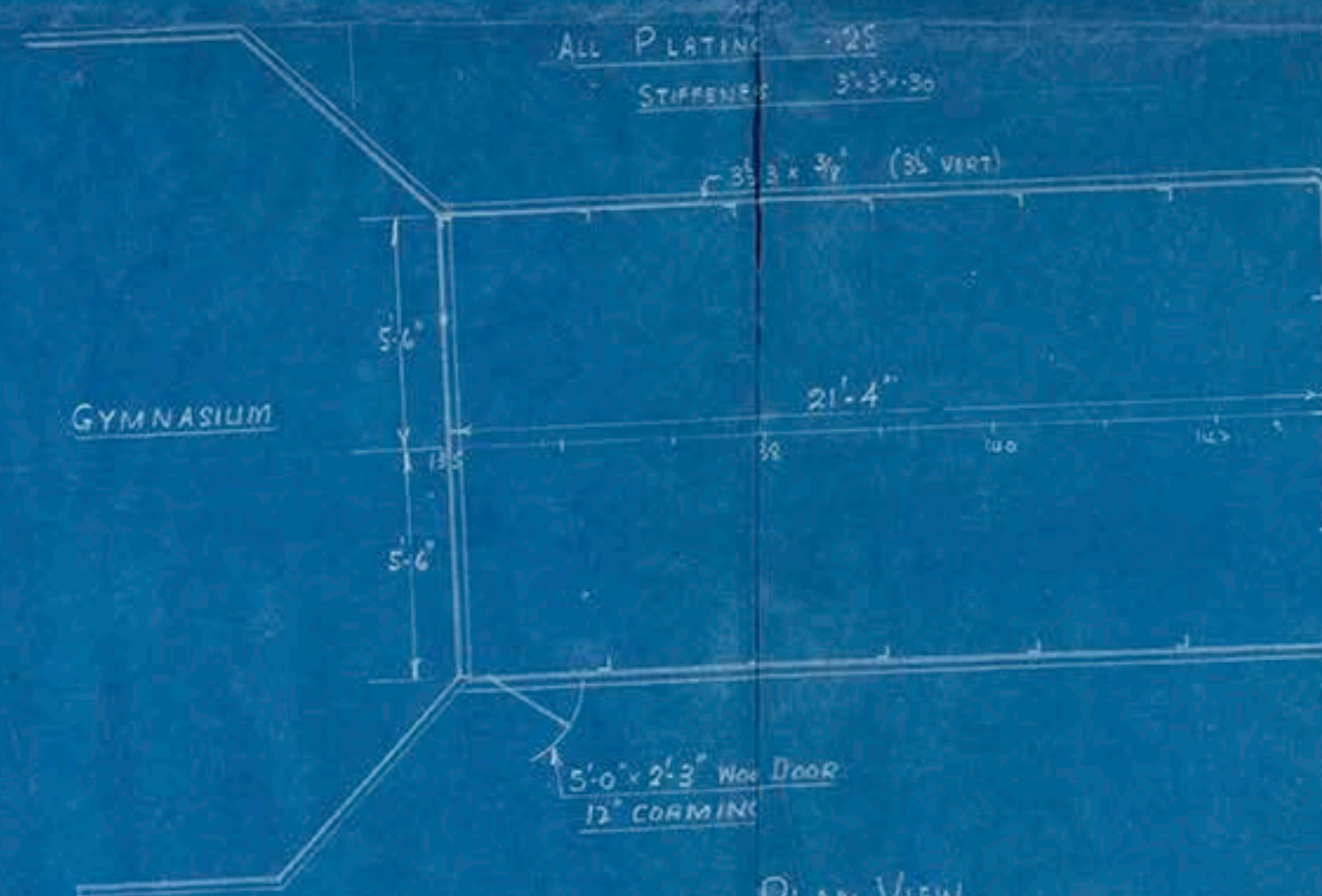

PLAN VIEW

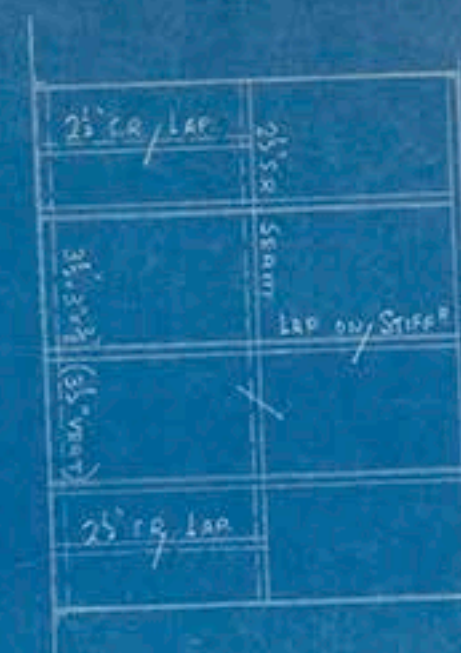

ELEVATION OF FORE END
LOOKING FORWARD

PALMERS HEBBURN CO. LTD.
DRAWING OFFICE,
HEBBURN-ON-TYNE.



© 2018

Lloyd's Register
Foundation

Job No 34/102

FAM CHAMBER ON
UPPER PROMENADE DECK
"ARANDORA STAR"

NWC: 97008.

LR-FAF-T831-P-45



© 2018

Lloyd's Register
Foundation