

T. S. S. "AWATEA."

RECESS IN W.T. BULKHEAD 65 DUE TO MODIFICATION TO THRUST BLOCK SEATING.

SCALE: $\frac{3}{8}$ INCH = ONE FOOT.

2522A. ITEM 2.

NOTES:- IN ORIGINAL BHD. STIFF FORMING BOUNDARY BARS OF W.T. RECESS.
ADDITIONAL RIVETS TO BE FITTED FOR CAULKING EDGES.
WHERE NECESSARY BUTTS OF BARS ETC. TO BE WELDED TO ENSURE WATERTIGHTNESS.

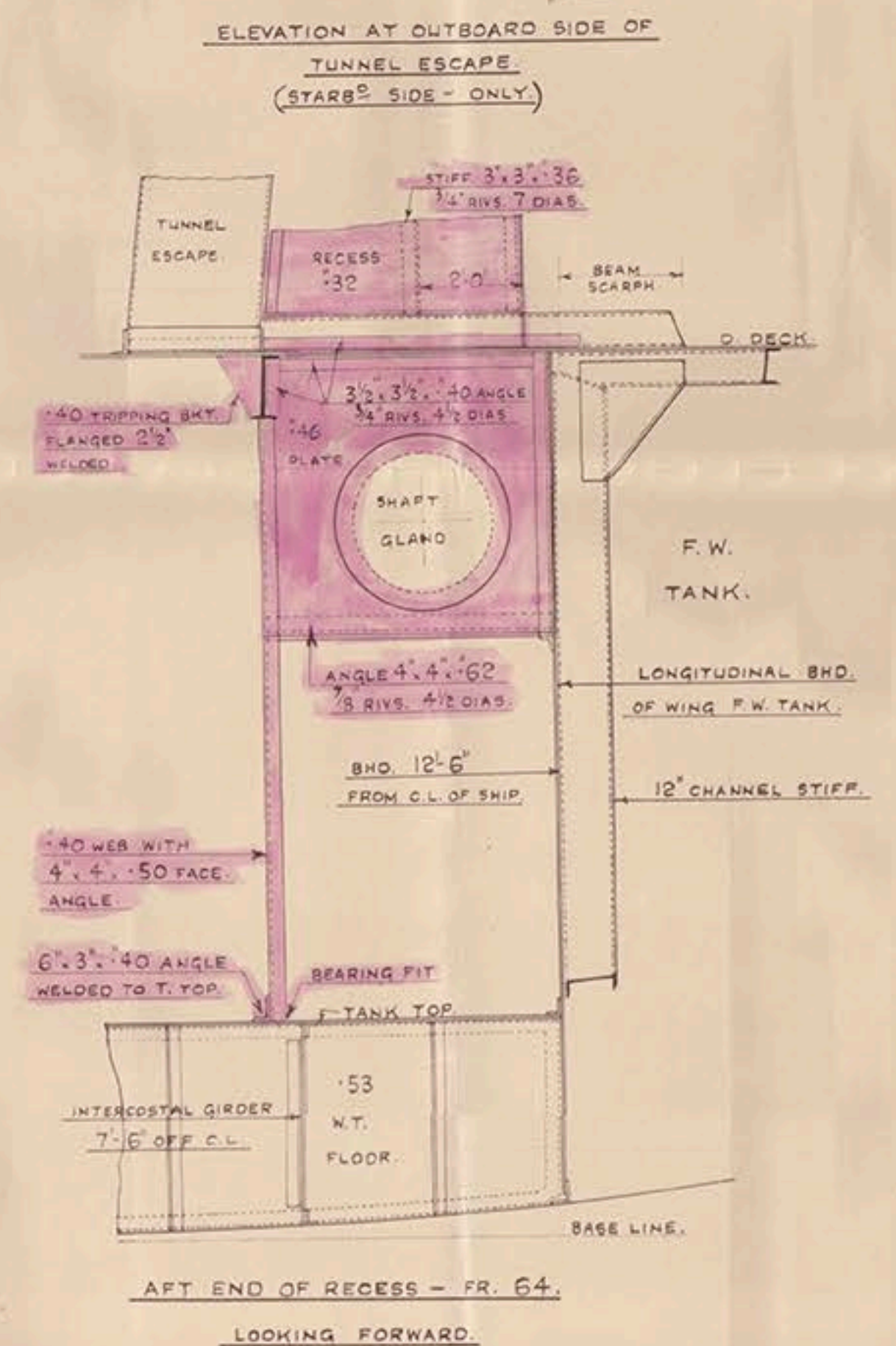
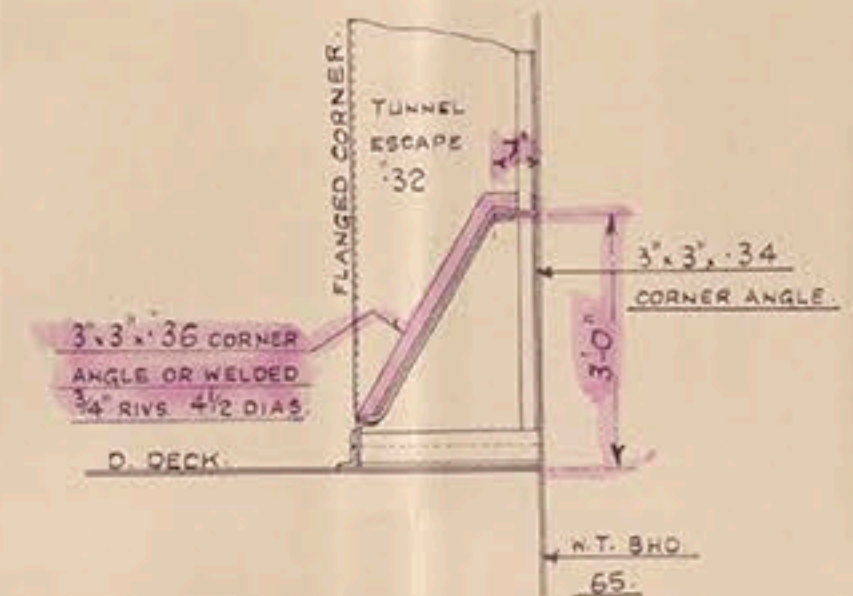
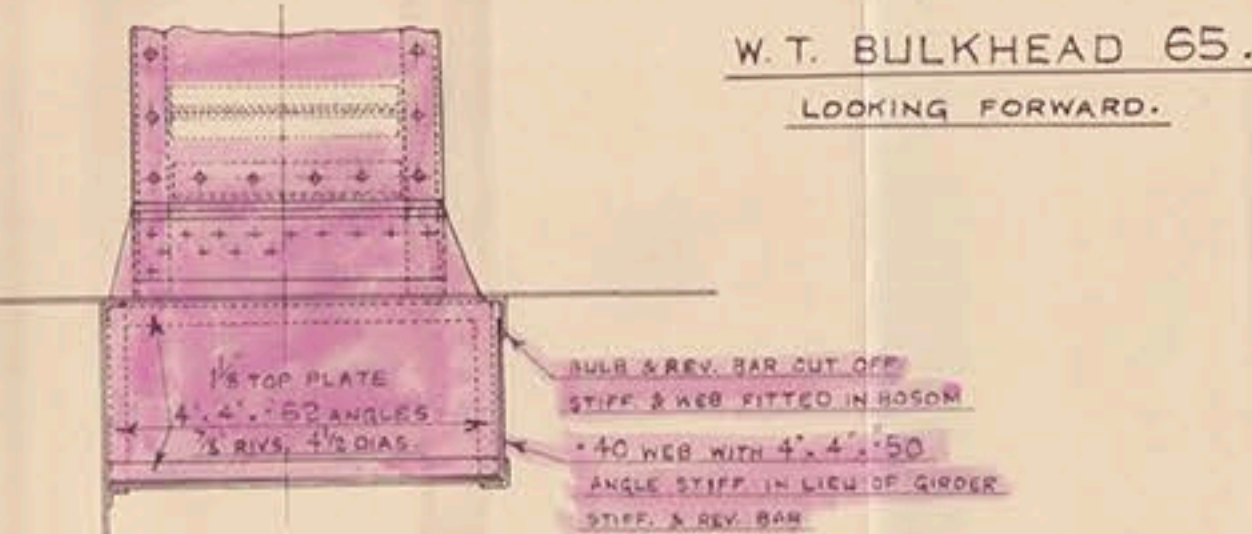
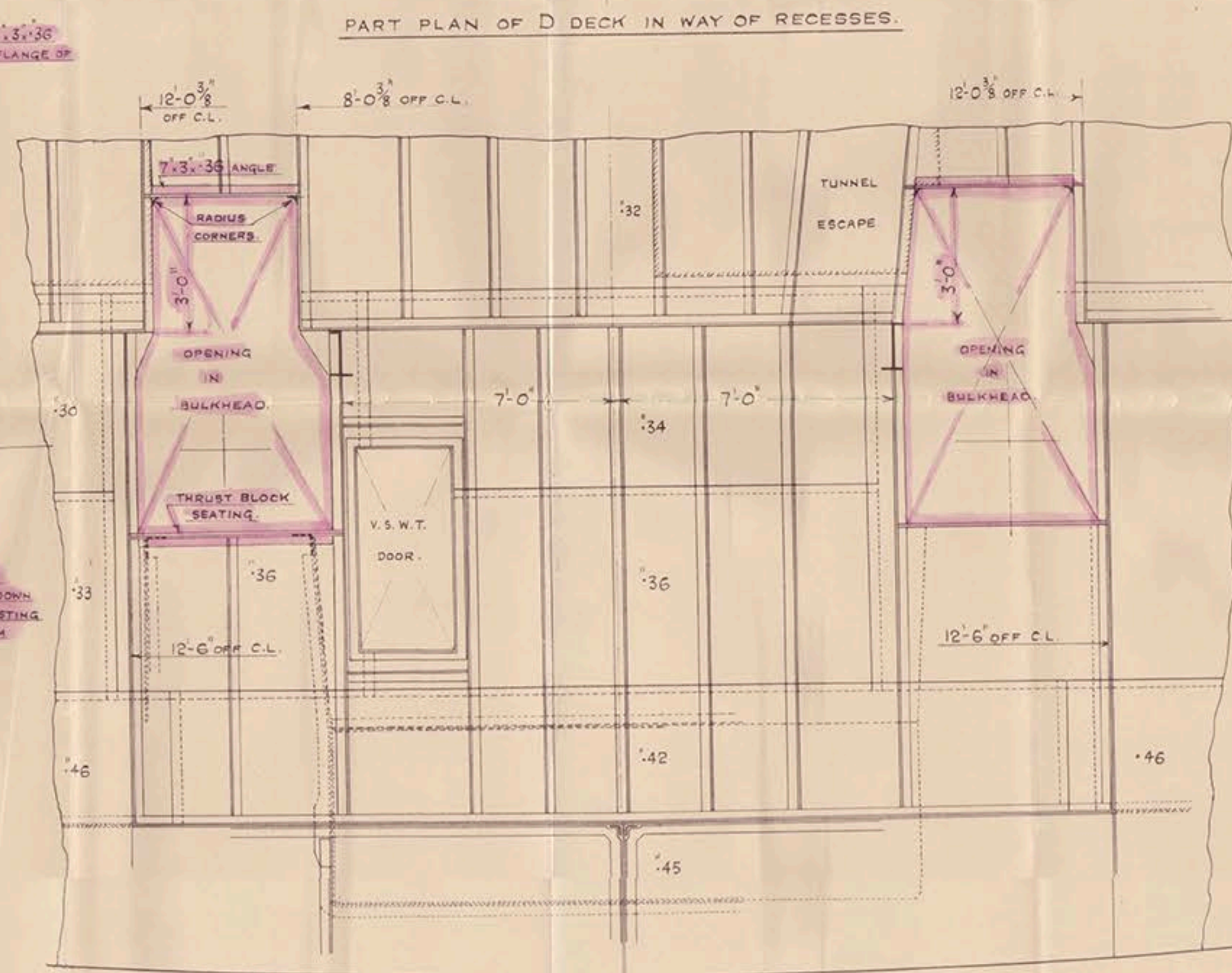
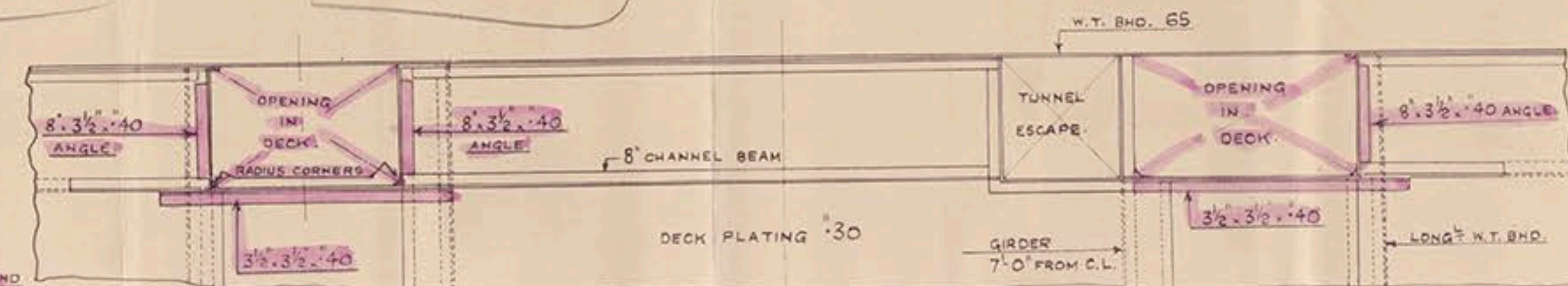
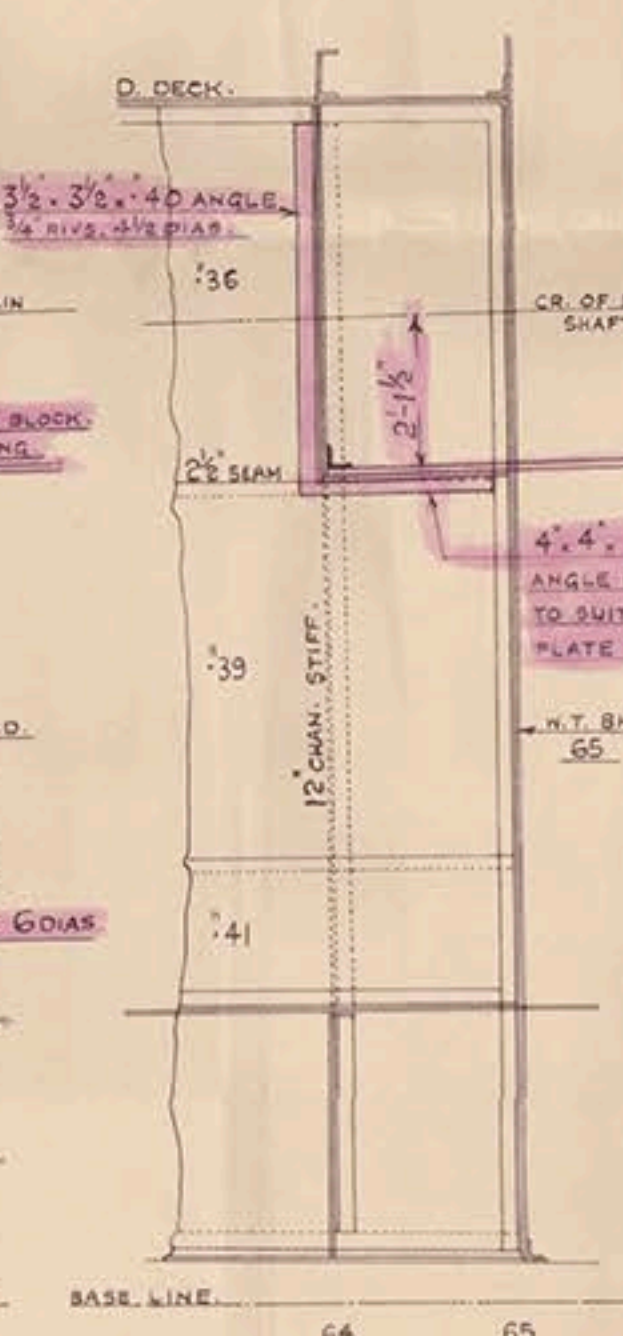
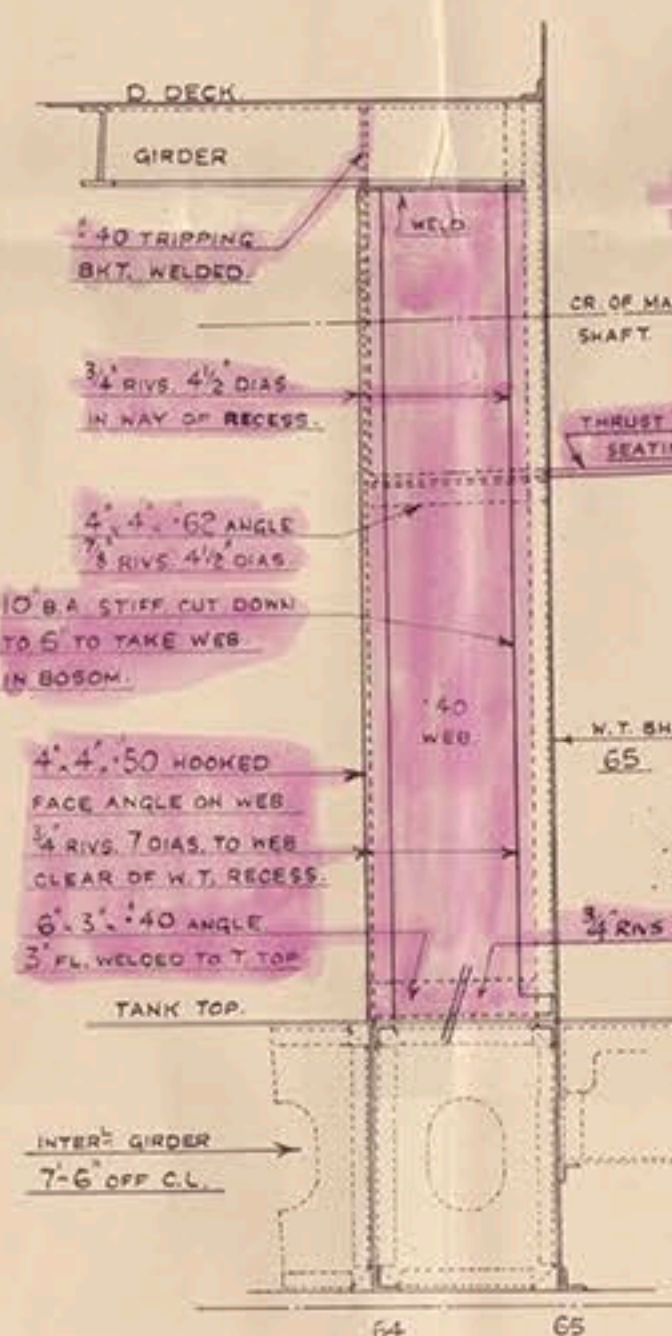
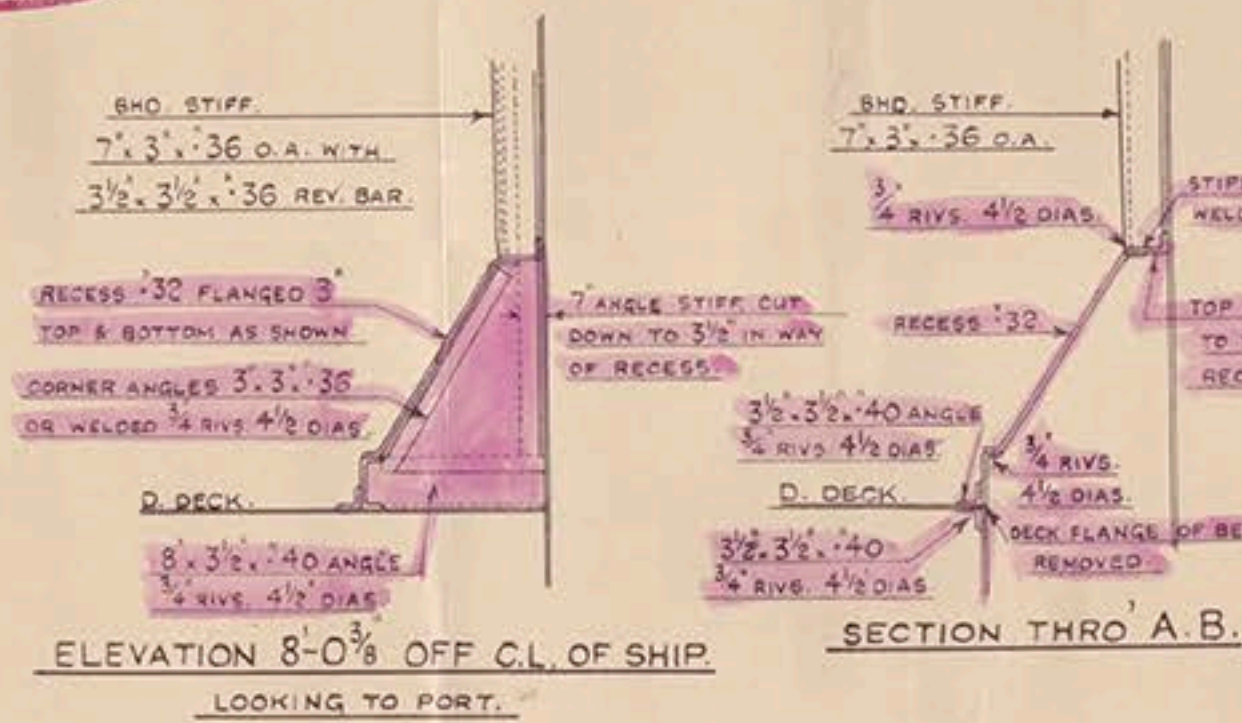

PLAN N^o 850.

See Bros
Letter 8/1/37

T. S. S. AWATEA

Proposed Modifications
to H.T. Bulkhead 65
and Thrust Sealing

Syd 15742.



© 2018

Lloyd's Register
Foundation

LR-FAF-T829-P-27